

DECK PLANS | INSIGNIA

SYMBOL LEGEND

- | | | |
|---------------------|-------------------------|--|
| ♣♣ Restrooms | ■ Quad with Pullman | ▲ Triple with Pullman |
| E Elevator | ★ ★ Quad with Sofabed | ★ Triple with Sofabed |
| 👕 Launderette | Connecting Staterooms | ◇ 3rd guest occupancy available upon request |
| OV Obstructed Views | ♿ Wheelchair Accessible | |

SHIPS' SPECIFICATIONS

Year Built: *Insignia* 1998 | Re-Inspiration Dates: *Insignia* 2018

Gross Tonnage: 30,277 | Length: 593.7 feet | Beam: 83.5 feet | Cruising Speed: 18 knots | Guest Decks: 9

Guest Capacity (Double Occupancy): 656 | Staff Size: 400 | Guest-to-Staff Ratio: 1.64 to 1

Nationality of Officers: European | Country of Registry: Marshall Islands

STATEROOM COLOR LEGEND

OS	VS	PH1	PH2	PH3	A1	A2	A3
B1	B2	C1	C2	D	S	F	G

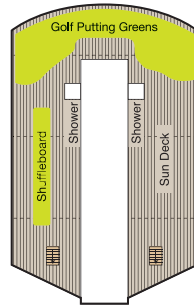

DECK 11

- Golf Putting Greens
- Shuffleboard
- Sun Deck

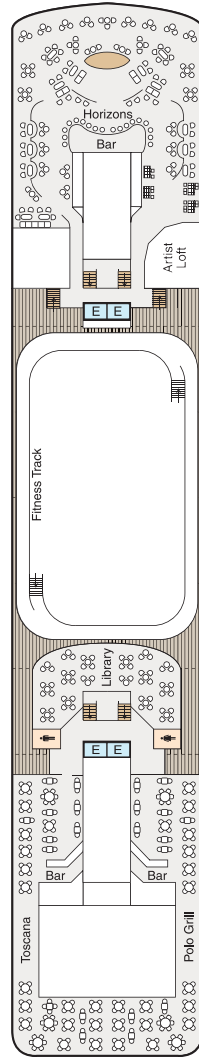

DECK 10

- Toscana
- Polo Grill
- Library
- Fitness Track
- Horizons
- Artist Loft, available on World Cruises

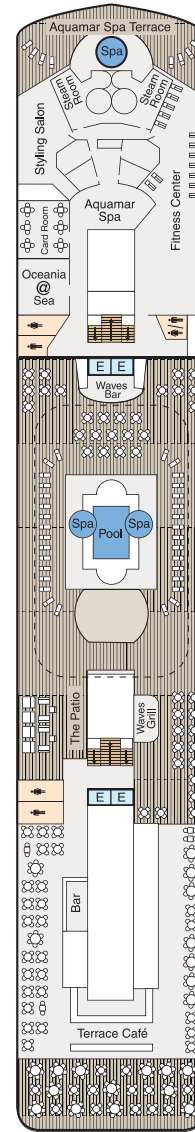

DECK 9

- Terrace Café
- Waves Grill
- Waves Bar
- Pool Deck
- Oceania@Sea
- Aquamar Spa + Vitality Center
- Aquamar Spa Terrace
- Fitness Center
- Salon

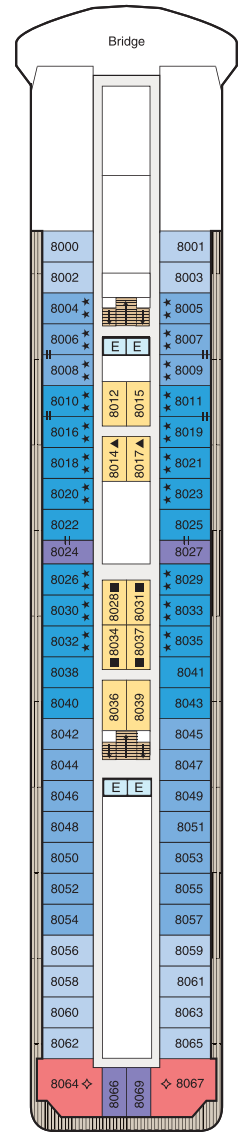

DECK 8

- Bridge
- Staterooms

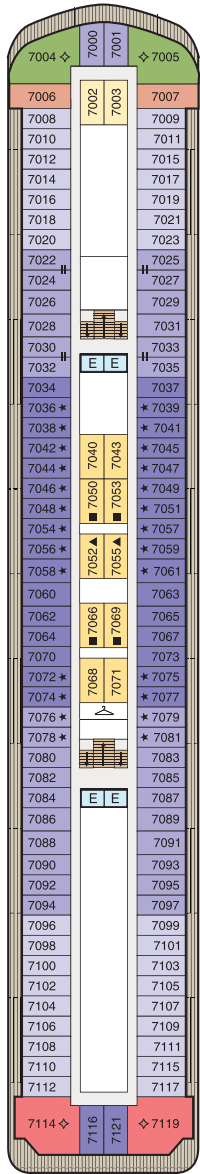

DECK 7

- Launderette
- Staterooms

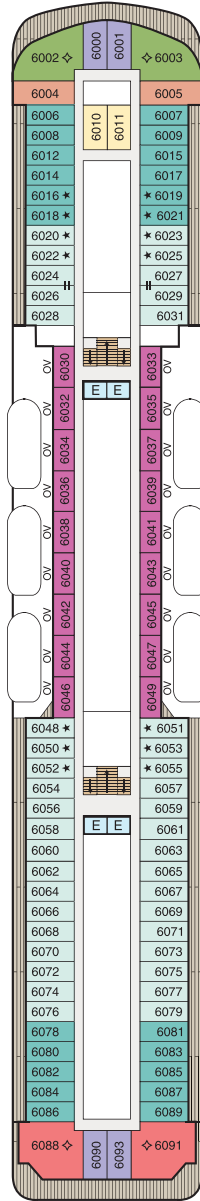

DECK 6

- Staterooms

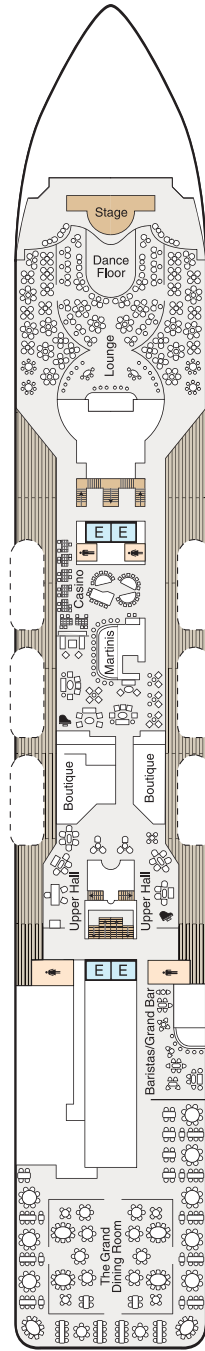

DECK 5

- Show Lounge
- Boutiques
- Upper Hall
- Oceania Club
- Ambassador Desk
- Martinis
- Casino
- Baristas
- The Grand Bar
- The Grand Dining Room

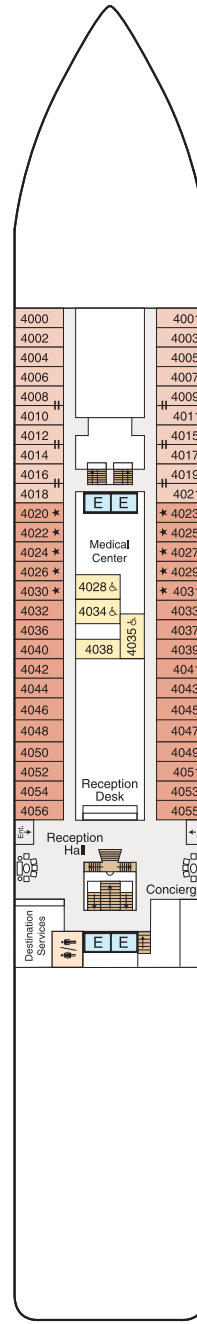

DECK 4

- Reception Desk
- Reception Hall
- Destination Services
- Concierge
- Medical Center
- Staterooms

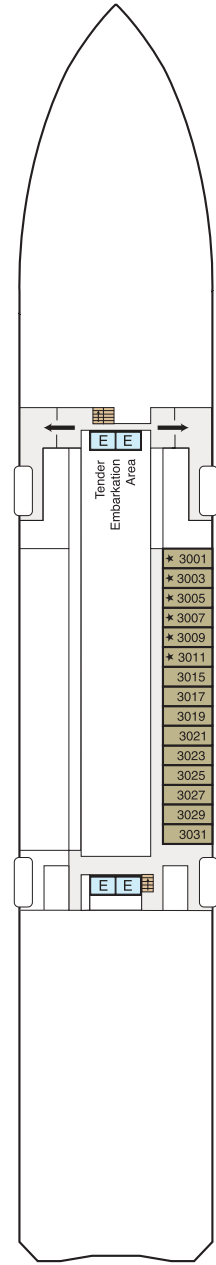

DECK 3

- Staterooms